

EXIST. AIRPORT BUILDING TABLE	
LETTER	DESCRIPTION
A	ADMINISTRATION/TERMINAL BUILDING
B	MUSEUM
C	HANGARS
D	SHADE HANGAR

ROAD CLEARANCE TABLE			
LOCATION NUMBER	APPROXIMATE APPROACH SURFACE ELEVATION	APPROXIMATE ROAD ELEVATION*	CLEARANCE (PENETRATION)
1	482.2	477.3	4.9'
2	481.7	477.3	4.4'
3	481.8	477.3	4.5'
4	465.0	465.0	0'
5	470.1	465.0	5.1'
6	482.5	465.0	17.5'
7	498.0	465.0	33.0'

*ROAD ELEVATIONS REFLECT A 15' OBSTACLE HEIGHT

GENERAL NOTES

- 1.) DUE TO FLOODING IN 1993, ACCURATE GROUND CONTOURS ARE NOT AVAILABLE AT THIS TIME. NO CONTOURS HAVE BEEN SHOWN ON THE AIRPORT LAYOUT PLAN.
- 2.) THE BUILDING RESTRICTION LINE ENCOMPASSES THE RUNWAY PROTECTION ZONES, THE RUNWAY VISIBILITY ZONE, AND ALL AIRPORT AREAS WITH LESS THAN 35 FOOT CLEARANCE UNDER F.A.R. PART 77 SURFACES.
- 3.) EXISTING RUNWAY END ELEVATIONS TAKEN FROM ADAM SURVEY AND COMPILATION REPORT DATED FEBRUARY 21, 1992.
- 4.) EXISTING RUNWAY 16/34 TO BECOME TAXIWAY UPON DEVELOPMENT OF PROPOSED RUNWAY 16/34.
- 5.) LAND ACQUISITION ALONG PROPOSED PAGE AVENUE IS BASED UPON A PRELIMINARY 400' R.O.W.
- 6.) THOSE BUILDINGS LOCATED WITHIN THE PROPOSED R.V.Z. (8 CORPORATE HANGARS AND THE SHADEPORT) ARE TO BE RELOCATED TO OUTSIDE THE R.V.Z.
- 7.) SEE THE TERMINAL AREA DRAWING, SHEET 3 FOR DETAILED LOCATIONS OF AIRCRAFT PARKING AND FUTURE TERMINAL AREA DETAILS.

LEGEND

EXISTING	PROPOSED	DESCRIPTION
---	---	AIRPORT PROPERTY LINE
---	---	RUNWAY PROTECTION ZONE (R.P.Z.)
---	---	AIRFIELD PAVEMENT
---	---	AIRPORT BUILDINGS
□	N/A	HOUSES AND OUTBUILDINGS
---	---	AVIGATION EASEMENT
---	---	BUILDING RESTRICTION LINE (B.R.L.)
---	---	RUNWAY AND TAXIWAY SAFETY AREA (R.S.A.)
---	---	OBJECT FREE AREA (O.F.A.)
---	---	RUNWAY VISIBILITY ZONE (R.V.Z.)
---	---	AIRCRAFT PARKING LIMITS (A.P.L.)
⊙	⊙	AIRPORT REFERENCE POINT (A.R.P.)
△△	△△	RUNWAY END IDENTIFIER LIGHT (REIL)
□□	□□	VISUAL GLIDE SLOPE INDICATOR (VGS)
⊙	⊙	THRESHOLD LIGHTS
⊙	⊙	NON-DIRECTIONAL BEACON (NDB)
⊙	⊙	AIRPORT ROTATING BEACON
⊙	⊙	WIND CONE
⊙	⊙	WIND CONE AND SEGMENTED CIRCLE
---	N/A	LAKES OR PONDS

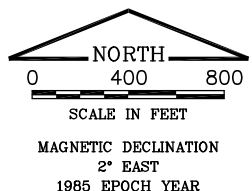
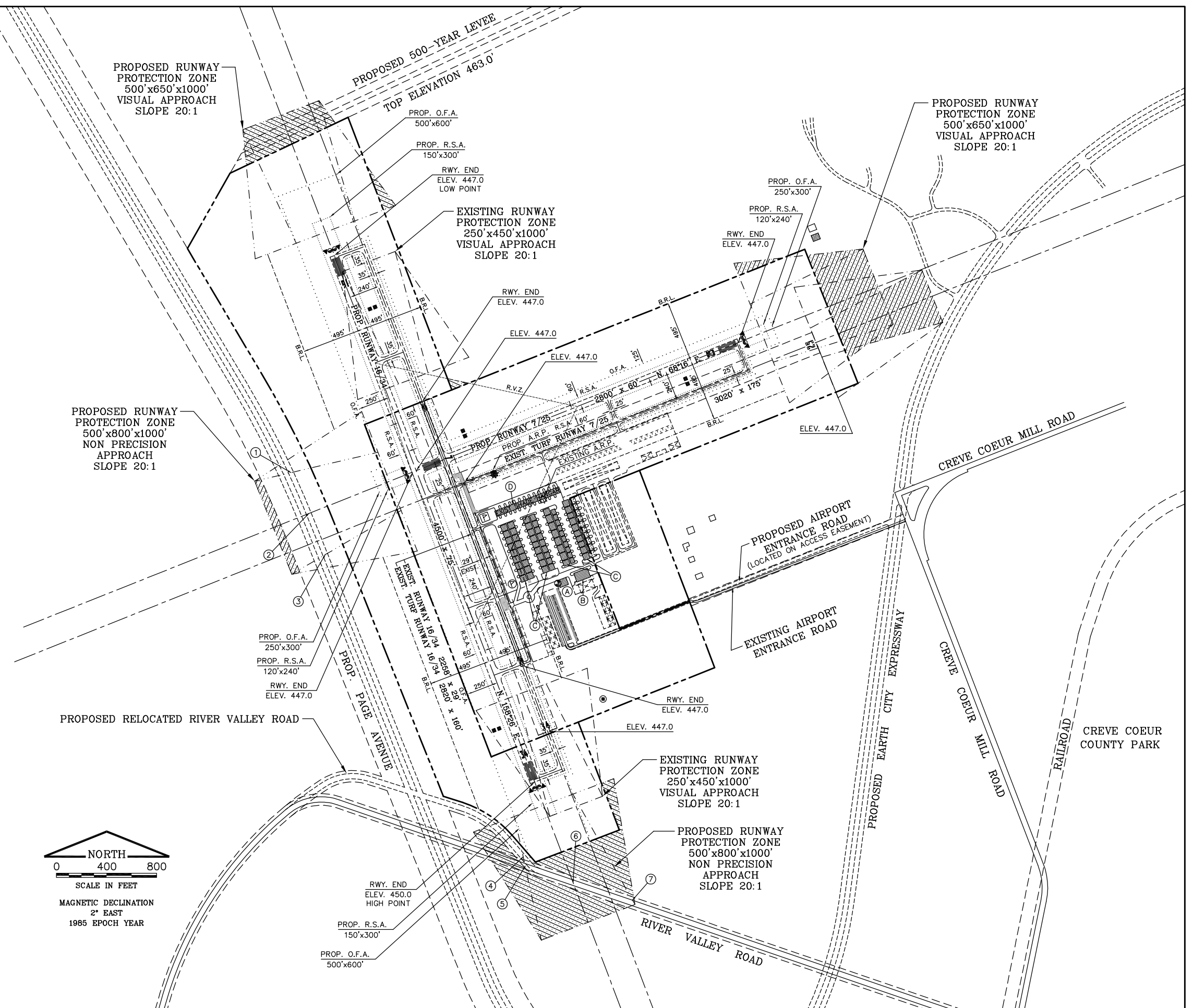

REVISIONS					
NO.	BY	DATE	NO.	BY	DATE
1	JP	3/11/96			

DESIGN BY	L.A.N.
DRAWN BY	M.R.W.
CHECKED BY	G.E.H.
APPROVED BY	M.J.D.

CREVE COEUR AIRPORT
MARYLAND HEIGHTS, MISSOURI

AIRPORT LAYOUT DRAWING